

This art project takes the close-up view of standing in the woods during a blizzard. You don't see the trees in full, merely the trunks layered one after another.

### MATERIALS:

For the canvas, grey cardboard cut in rectangles. We used size 8 ½" x 5 ½".

*Cardboard cut from cereal boxes works just as well as grey cardboard. Board can also be purchased online or from a craft store.*

Black acrylic paint (Can also use black tempera paint; it just doesn't cover as well).

White acrylic paint (Can also use white tempera paint; it just doesn't cover as well).

Painter's tape (Spend a few cents more and buy a quality brand of painter's tape. Cheap tape will likely tear off the canvas border, and the painting, when you remove it).

Some kind of surface to tape the canvas onto (we used a piece of cardboard)

Stiff paint brush

Soft paint brush

Cardboard box to do the splatter paint in

Newspaper or such to cover your work space

Paper towels or rags for messes

Recommended: large 'paint shirt' to cover your clothes (for when you do the splatter painting)

**STEP 1:** Tape the cardboard canvas down to your surface; cover about ½" of the edge. *Creating this mat around the edge adds a nice touch to the finished art piece, plus it holds it in place.*

**STEP 2:** Squeeze out a small amount of black paint in a jar lid or similar, and paint vertical lines (tree trunks) with the stiff paint brush.

The bottoms should be staggered but the tops should go up to the tape line.

Don't worry about making a solid black line, it looks better with some of the background coming through.

If desired, you can paint it so that the trees that you want to appear closer to the viewer are wider than the trees that are further away.

Let it dry.

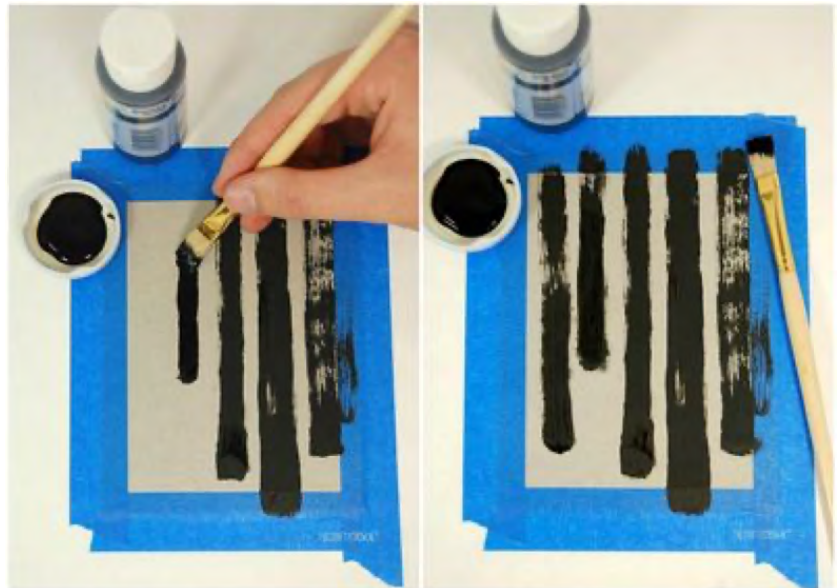

## MAKE & PAINT: Snowy Woods



**STEP 3:** Put the taped canvas in the bottom of a cardboard box for splatter painting.

Squeeze some white paint in a small dish and, if using acrylic paint, add a bit of water. Use the soft paint brush for splattering. The paint should hold on your brush but flick off easily.

Start splattering paint onto your tree trunks. Hold the brush and gently tap it with your other fingers. You can decide how long you want to "watch the woods fill up with snow"!

You can also "fling" the paintbrush to add long thin strands of snow onto the canvas; but watch out, it will fly!

Remove the taped canvas from the cardboard box.



**STEP 4:** Use the soft paint brush to add more snow at the bottom.

Let it dry.

**STEP 5:** Gently, carefully, & slowly remove the painter's tape from around the canvas (an adult may want to do this part).

To avoid tearing the cardboard canvas and the painting off with the tape, use a higher-quality, name brand painter's tape.

Also, **do not quickly** pull the tape off. Do not pull it off along a straight line.



*Project inspired by Robert Frost's  
"Stopping by Woods on a Snowy  
Evening," illustrated by Susan Jeffers.*

*Photos from The Crafty Crow website.*

